



CRESCENT

Distinctive and attractive architectural luminaire.
Surface mount with a choice of VDT louvre or perforated
diffuser providing indirect vertical and horizontal
illuminance levels with soft light effect.



Lighting for
a Living

CRESCENT

Surface indirect/direct module with VDT
louvre or perforated diffuser

Features

- Distinctive and attractive architectural surface module
- Indirect lighting with choice of easy fix VDT louvre or perforated diffuser
- Twin T5 lamps in either high efficiency or high output
- High quality white reflector with optimum lamp position
- Full range of dimmable and emergency options
- 5 years ballast warranty

Construction

- White powder-coated steel body
- Aluminium parabolic VDT louvre or white painted steel perforated diffuser
- High quality electronic ballast and lamps
- Injection moulded polycarbonate end caps

To Specify/Order

- Surface indirect/direct module with VDT louvre or perforated basket as per TamLite 'CRESCENT' range

Order Codes

| Surface indirect/direct module with perforated diffuser | | | Dimensions (mm) | | |
|---|---------------|----------|-----------------|-------|-------|
| Order Code | Lamps | Wgt (kg) | Dim A | Dim B | Dim C |
| CRE228 | 2 x 28W T5 | 5.50 | 1190 | 295 | 115 |
| CRE254 | 2 x 54W T5 HO | 5.50 | 1190 | 295 | 115 |
| CRE235 | 2 x 35W T5 | 8.40 | 1490 | 295 | 115 |
| CRE249 | 2 x 49W T5 HO | 8.40 | 1490 | 295 | 115 |

| Surface indirect/indirect module with VDT louvre | | | Dimensions (mm) | | |
|--|---------------|----------|-----------------|-------|-------|
| Order Code | Lamps | Wgt (kg) | Dim A | Dim B | Dim C |
| CRE228/VDT | 2 x 28W T5 | 5.20 | 1190 | 295 | 110 |
| CRE254/VDT | 2 x 54W T5 HO | 5.20 | 1190 | 295 | 110 |
| CRE235/VDT | 2 x 35W T5 | 8.10 | 1490 | 295 | 110 |
| CRE249/VDT | 2 x 49W T5 HO | 8.10 | 1490 | 295 | 110 |

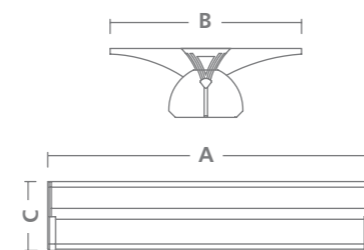
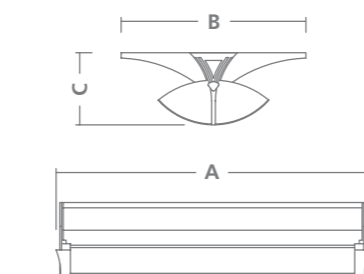

Options

| Suffix | Description |
|--------|---------------------------------|
| /M3 | 3 hour emergency version |
| /HFD | Digital (DSI) dimmable versions |

Easy Fix



About Us

Tamlite Lighting continue to offer a superior range of products and services within all sectors of the Lighting and Fire Detection market to provide best value, best solution and a complete package for designers, architects and installers throughout the U.K. and Ireland.

Lighting for work and lighting for play or lighting for night and lighting for day. Tamlite Lighting have 40 years of experience in providing lighting solutions for everyday needs. The dedication and skills of our 'Lighting Team' are the key asset in creating a lighting environment that is functional, comfortable and practical.

All products are distributed through the UK's largest network of wholesale outlets: City Electrical Factors with over 400 branches in the British Isles and almost 1000 more premises in mainland Europe, the Middle East, North America and Australia.

Each branch provides the customer with a service that is second to none as well as stocking a wide range of Tamlite Lighting products.

www.cef.co.uk



Visit our all new website 'Tamlite.co.uk' to browse products and projects, and be updated on our latest and greatest news on all luminaires, applications and services available from Tamlite Lighting.



Contact Us

Sales Centre

Tamlite Field Sales Centre, The Sales Centre,
Park Farm Industrial Estate, Redditch,
Worcestershire, B98 0HU

T. 01527 517 777
F. 01527 517 666
E. sales@tamlite.co.uk
W. www.tamlite.co.uk

Technical Department

Stafford Park 12, Telford
Shropshire, TF3 3BJ

T. 01952 292 441
F. 01952 292 155
E. technical@tamlite.co.uk

